

CONTINUOUS CASTING

GV

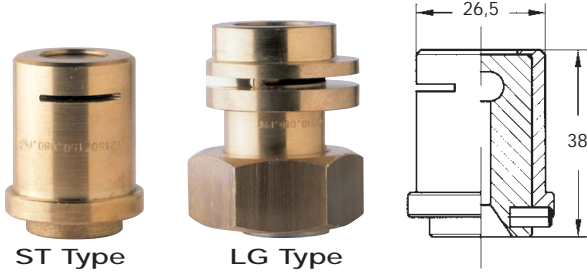

FLAT JET NOZZLES / SLIT TYPE

The slit type flat jet offer a very wide coverage, and a very thin flat spray which can be used in machines with limited space between rollers. The jet produces a remarkably even distribution and it is obtained by means of an inside profile which greatly reduces the danger of clogging, and the finely atomized spray provides for uniform coverage through the narrow gaps between rollers. These nozzles are locked in place by means of a specific locknut. Nozzles with capacity codes equal or higher than 2300 are fitted with an additional body lip, which makes it impossible to slip the nozzle inside the locknut. They are therefore delivered with a locknut which is pre-assembled at the factory.

Connection 1" BSP female cap & nipple
Material T1 Brass

	GVV	GVU	GVT	Tip Code	Capacities at different pressure values								W (kg)	
					1.0	1.5	2.0	2.8	3.0	3.5	4.0	4.5		5.0
ST Type	•	•	•	1500 T1	2.90	3.70	4.20	5.00	5.18	5.59	6.00	6.36	6.70	0,15
	•	•	•	1750 T1	4.50	5.50	6.30	7.50	7.80	8.40	9.00	9.54	10.0	
	•	•	•	2100 T1	6.00	7.30	8.40	10.0	10.3	11.2	12.0	12.7	13.4	
	•	•	•	2120 T1	7.20	8.80	10.1	12.0	12.4	13.4	14.4	15.3	16.0	
	•	•	•	2150 T1	9.00	11.0	12.7	15.0	15.6	16.8	17.9	19.0	20.0	
	•	•	•	2200 T1	11.9	14.6	16.9	20.0	20.7	22.4	23.9	25.3	26.7	
LG Type	•	•	•	2300 T1	17.9	22.0	25.3	30.0	31.1	33.5	35.9	37.1	40.1	0,36
	•	•	•	2350 T1	20.9	25.6	29.6	35.0	36.2	39.1	41.9	44.4	46.8	
	•	•	•	2450 T1	26.9	32.9	38.0	45.0	46.6	50.3	53.8	57.1	60.2	
	•	•	•	2450 T1	26.9	32.9	38.0	45.0	46.6	50.3	53.8	57.1	60.2	
	•	•	•	2500 T1	29.9	36.6	42.3	50.0	51.8	55.8	59.8	63.4	66.8	



VAA 0100 T1

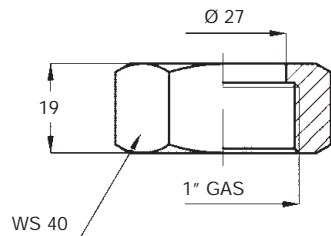

LOCKNUT

GV style nozzles are fixed by means of their specific locknut VAC 0100 T1 to the nipple onto main manifold.

The nut can be ordered separately as a spare part. Connection 1" BSP female.

Weight 0,1 kg

KYA



ROLL COOLING NOZZLES

These special nozzles have been designed to achieve satisfactory roller cooling in continuous casting machines with large casting width.

The direction of the two water jets is designed so as to obtain the optimum coverage on the roller length.

Table shows typical nozzles, while capacity, connection and outside dimensions can be made as requested.

Connection Metric thread 30x2
Material T1 Brass

Tip Code	Nozzle capacity at pressure values								(lpm) (bar)
	1.0	2.0	3.0	4.0	5.0	6.0	7.0	10.0	
KYA 1510 T1	2.94	4.16	5.10	5.89	6.58	7.21	7.79	9.31	
KYA 1790 T1	4.56	6.45	7.90	9.12	10.2	11.2	12.1	14.4	
KYA 2107 T1	6.18	8.74	10.7	12.4	13.8	15.1	16.3	19.5	