

TWIN AXIS HEADS

POSITIVE DRIVE

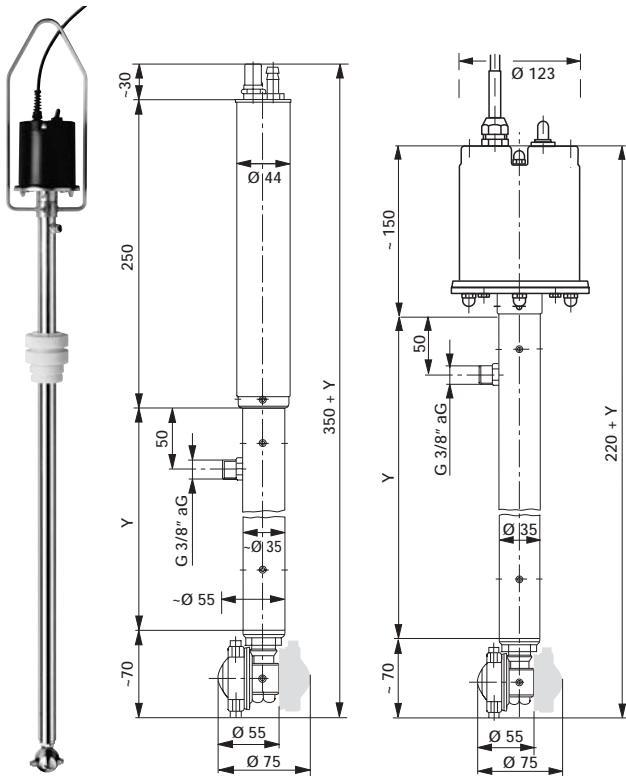

UBG

These proven units are powered from electric or compressed air motors located outside the tank, and assure the most reliable washing operation where the only shaft is protruding inside the tank.

The high quality motors and the stainless steel mechanism assure for years long trouble-free service, while a choice of models covers a wide application requirement range, with pressures up to 250 bar and capacities to 80 lpm, different shaft lengths and choice between 2 or 4 nozzles heads to better suit your washing cycle specifications.

The liquid capacity depends upon the size of its spray nozzles. Capacities for several sizes of nozzles are given in the table below, where the capacity is understood for a head equipped with two nozzles of the given size, and it must be doubled for double heads fitted with four nozzles.

Shaft lengths 1.0, 1.5 or 2.0 meters, see drawings for total length. Accessories, and specifications about air and electric motors, can be found at page 13.

Materials

Mechanical parts B3 Aisi 316 stainless steel

TANKWASHER CODE

UBG tankwashers code includes all the possible options, and it must be completed by means of the table below, choosing the appropriate value for X, Y and Z.

UBG 12 x y B3 z B

Please complete the code as follows

- X Motor type A = Air E = Electric
- Y Shaft length A = 1.0 m B = 1.5 m C = 2.0 m
- Z Tank mount A = Adapter B = Threaded ring C = Flange Z = None

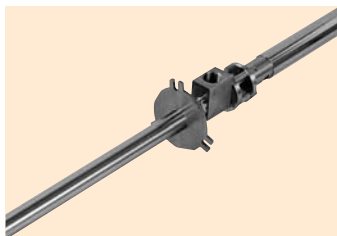

We supply mounting flanges to Customer design, or to any international Standard.

Code	NZ	Capacity at different pressures							lpm bar	Dimensions		
		10	20	30	50	70	90	135		TL	DL	RF
UBG 12xy B3 zB	05	7	10	12	16	19	22	27	55	75	1"	
UBG 18xy B3 zB	06	9	12	15	19	23	26	32				
UBG 24xy B3 zB	07	10	14	17	22	27	30	37				
UBG 36xy B3 zB	08	12	16	20	26	31	35	43				
UBG 48xy B3 zB	09	13	18	23	29	34	39	48				
UBG 54xy B3 zB	10	14	20	25	32	38	43	53				

Capacity values shown in the table only show the highest value that can be obtained through a rotating head fitted with two nozzles having the size shown under the column NZ.

The precise capacity being sprayed into the tank depends upon friction losses between the pump outlet and the nozzles.

Additional technical details are given at page 13.